

# Stepper MOTOR

28S10 Flat Hybrid Stepper

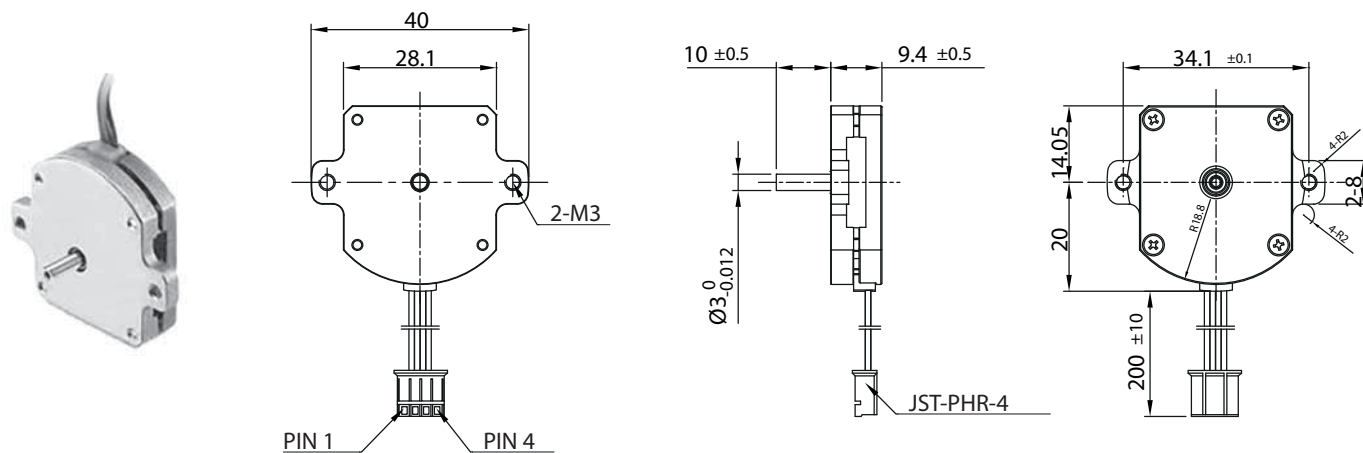

## Characteristics

STEP ANGLE  
1,8°

STEP ANGLE ACCURACY  
± 5%

INSULATION CLASS  
B

AMBIENT TEMPERATURE  
-20°C +50°C

TEMP. RISE  
80°C MAX (RATED CURRENT, 2 PHASE ON)

INSULATION RESISTANCE  
100 M OHM MIN. 500 VDC

DIELECTRIC STRENGTH  
500 VAC/50Hz/1 SEC/3mA

SHAFT RADIAL PLAY  
0,06 MAX ( 450 G LOAD)

SHAFT AXIAL PLAY  
0,04 MAX. ( 450 G LOAD)

MAX RADIAL FORCE  
4.5 N ( 10 MM FROM FRONT FLANGE)

MAX AXIAL FORCE  
4.5 N

## Specification

| Model              | 28S10-0504        |        |  |
|--------------------|-------------------|--------|--|
| 1 RATED VOLTAGE    | V                 | 1,85   |  |
| 2 CURRENT/PHASE    | A                 | 0,5    |  |
| 3 RESISTANCE/PHASE | Ω                 | 3,7    |  |
| 4 INDUCTANCE/PHASE | mH                | 0,88   |  |
| 5 HOLDING TORQUE   | NM                | 0,0098 |  |
| 6 ROTOR INERTIA    | G-CM <sup>2</sup> | 1,7    |  |
| 7 WEIGHT           | KG                | 0,028  |  |
| 8 NUMBER OF LEADS  | N°                | 4      |  |

## Connection

| LEAD N° | COLOR  | GAUGE        | FUNCTION |
|---------|--------|--------------|----------|
| 1       | RED    | UL1061 AWG26 | PHASE A  |
| 2       | BLUE   | UL1061 AWG26 | PHASE A- |
| 3       | ORANGE | UL1061 AWG26 | PHASE B  |
| 4       | YELLOW | UL1061 AWG26 | PHASE B- |

