

## SPECIFICATION

Model		32BLW18-9V	32BLW18-12V	
1	N° OF POLE	8	8	
2	N° OF PHASE	3	3	
3	RATED VOLTAGE	V	9	12
4	RATED SPEED	rpm	2100	2800
5	RATED TORQUE	Nm	0,025	0,025
6	MAX PEAK TORQUE	Nm	0,075	0,075
7	TORQUE CONSTANT	Nm/A	0,023	0,025
8	LINE TO LINE RESISTANCE	Ω	3	3
9	LINE TO LINE INDUCTANCE	mH	1,6	1,9
10	MAX PEAK CURRENT	A	3,4	3,2
11	RATED CURRENT	A	1,09	1
12	NO-LOAD CURRENT	mA	290	190
13	LENGTH	mm	17,9	17,9
14	ROTOR INERTIA	g-cm <sup>2</sup>	35	35
15	WEIGHT	Kg	0,05	0,05



## CONNECTION

Pin N°	Connector	Function
1	PFC CABLE	+ 5V/DC
2	PFC CABLE	HALL C
3	PFC CABLE	HALL A
4	PFC CABLE	HALL B
5	PFC CABLE	GND
6	PFC CABLE	PHASE W
7	PFC CABLE	PHASE V
8	PFC CABLE	PHASE U

## CHARACTERISTICS

Item	
HALL EFFECT ANGLE	120°
SHAFT RUN OUT	0,03 mm
INSULATION CLASS	B
RADIAL PLAY (450 g LOAD)	0,02 mm
AXIAL PLAY (450 g LOAD)	0,06 mm
MAX RADIAL FORCE (10 mm FROM FRONT FLANGE)	14N
MAX AXIAL FORCE	4N
DIELECTRIC STRENGTH	250 VAC FOR ONE MINUTE
INSULATION RESISTANCE	100 Mohm min. 500 VDC

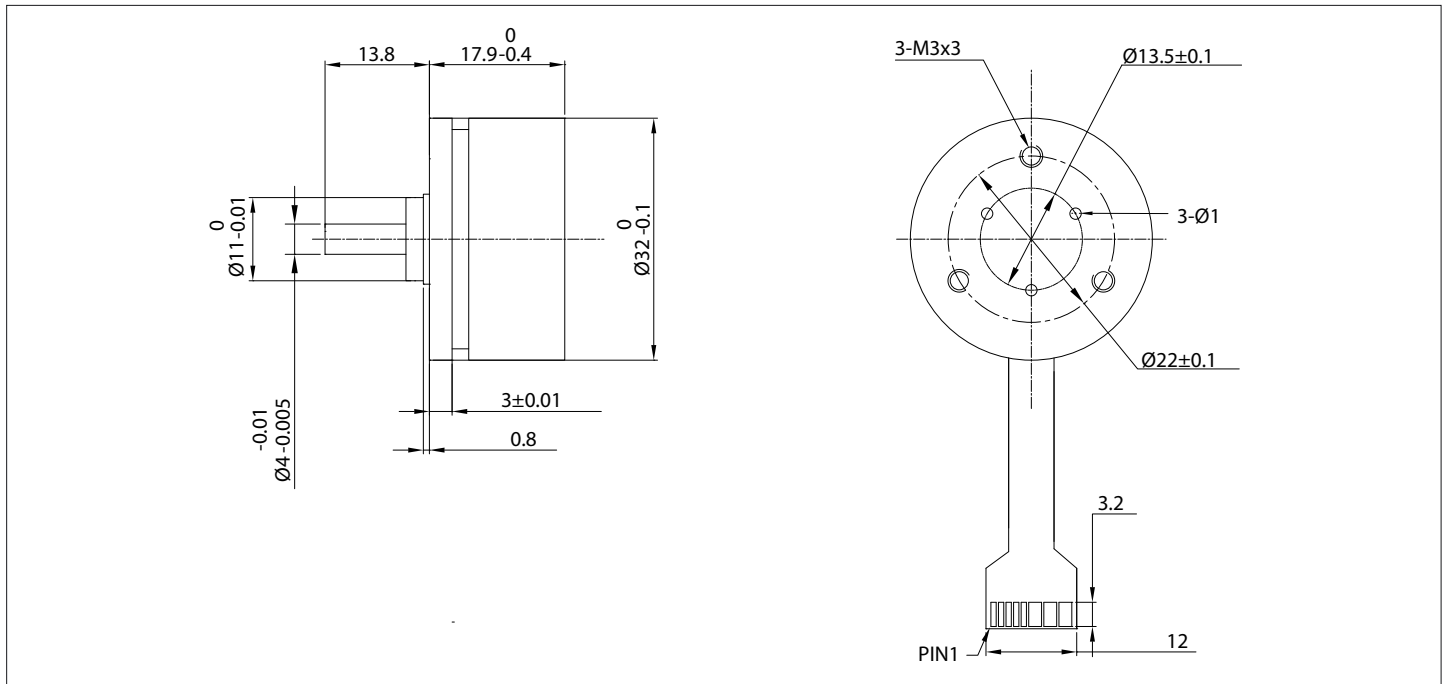

## SPECIFICATION

Model		32BLW18-24V	32BLW18-48V	
1	N° OF POLE	8	8	
2	N° OF PHASE	3	3	
3	RATED VOLTAGE	V	24	48
4	RATED SPEED	rpm	2760	2950
5	RATED TORQUE	Nm	0,026	0,025
6	MAX PEAK TORQUE	Nm	0,075	0,075
7	TORQUE CONSTANT	Nm/A	0,051	0,096
8	LINE TO LINE RESISTANCE	Ω	13	53
9	LINE TO LINE INDUCTANCE	mH	7,7	28
10	MAX PEAK CURRENT	A	1,7	0,97
11	RATED CURRENT	A	0,51	0,26
12	NO-LOAD CURRENT	mA	100	90
13	LENGTH	mm	17,9	17,9
14	ROTOR INERTIA	g-cm <sup>2</sup>	35	35
15	WEIGHT	Kg	0,05	0,05



## CONNECTION

Pin N°	Connector	Function
1	PFC CABLE	+ 5V DC
2	PFC CABLE	HALL C
3	PFC CABLE	HALL A
4	PFC CABLE	HALL B
5	PFC CABLE	GND
6	PFC CABLE	PHASE W
7	PFC CABLE	PHASE V
8	PFC CABLE	PHASE U

## CHARACTERISTICS

Item	
HALL EFFECT ANGLE	120°
SHAFT RUN OUT	0,03 mm
INSULATION CLASS	B
RADIAL PLAY (450 g LOAD)	0,02 mm
AXIAL PLAY (450 g LOAD)	0,06 mm
MAX RADIAL FORCE (10 mm FROM FRONT FLANGE)	14N
MAX AXIAL FORCE	4N
DIELECTRIC STRENGTH	250 VAC FOR ONE MINUTE
INSULATION RESISTANCE	100 Mohm min. 500 VDC