

SPECIFICATION

Model		57BLA01	57BLA02
1	N° OF POLE	6	6
2	N° OF PHASE	3	3
3	RATED VOLTAGE	V	36
4	RATED SPEED	rpm	4000
5	RATED TORQUE	Nm	0,2
6	MAX PEAK TORQUE	Nm	0,6
7	TORQUE CONSTANT	Nm/A	0,07
8	LINE TO LINE RESISTANCE	Ω	0,95
9	LINE TO LINE INDUCTANCE	mH	1,2
10	MAX PEAK CURRENT	A	8,6
11	RATED CURRENT	A	2,86
12	NO-LOAD CURRENT	mA	350
13	LENGTH	mm	53,6
14	ROTOR INERTIA	g-cm ²	275
15	WEIGHT	Kg	0,52



CONNECTION

Lead N°	Color	Gauge	Function
1	RED	UL1430 AWG26	VCC HALL SENSOR +5 TO +24 VDC
2	BLUE	UL1430 AWG26	HALL A
3	GREEN	UL1430 AWG26	HALL B
4	WHITE	UL1430 AWG26	HALL C
5	BLACK	UL1430 AWG26	HALL SENSOR GROUND
6	YELLOW	UL1430 AWG20	PHASE U
7	RED	UL1430 AWG20	PHASE V
8	BLACK	UL1430 AWG20	PHASE W

CHARACTERISTICS

Item	
HALL EFFECT ANGLE	120°
SHAFT RUN OUT	0,025 mm
INSULATION CLASS	F
RADIAL PLAY (460 g LOAD)	0,025 mm
AXIAL PLAY (4000 g LOAD)	0,025 mm
MAX RADIAL FORCE (20 mm FROM FRONT FLANGE)	115N
MAX AXIAL FORCE	45N
DIELECTRIC STRENGTH	500 VAC FOR ONE MINUTE
INSULATION RESISTANCE	100 Mohm min. 500 VDC

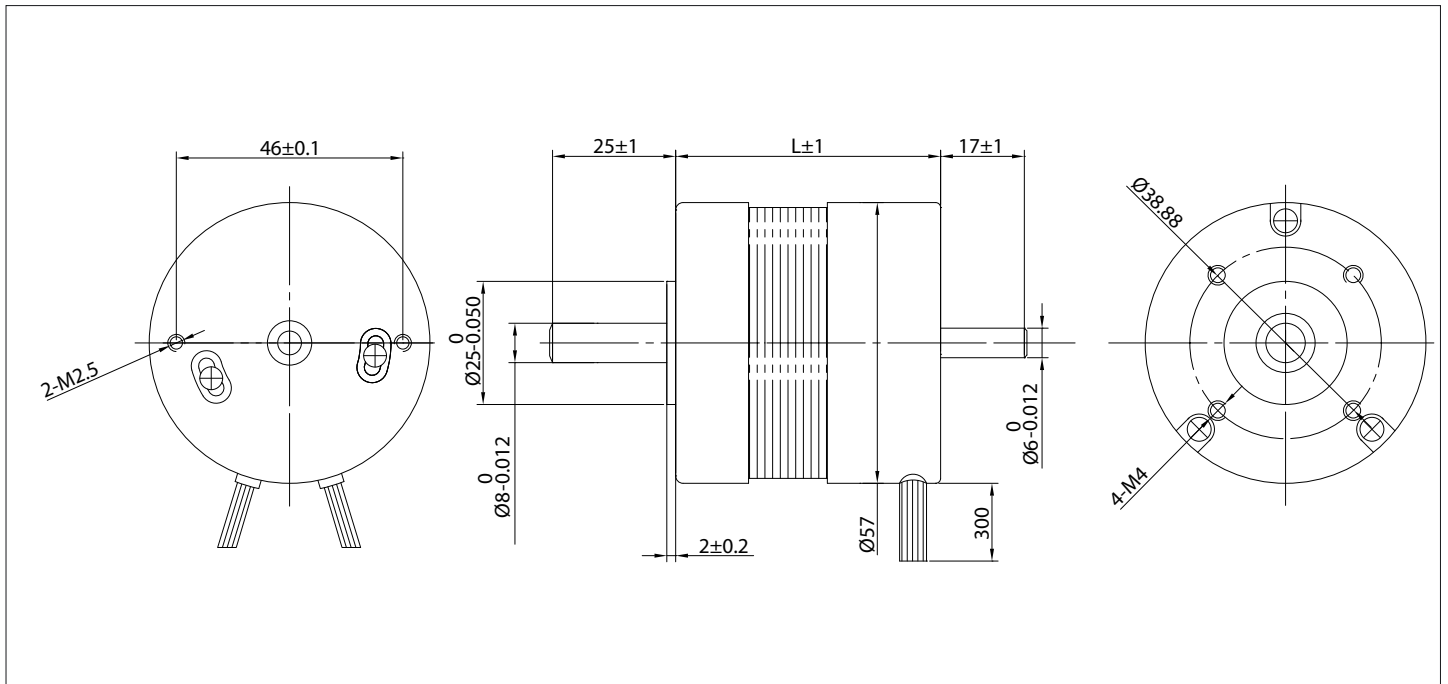

SPECIFICATION

Model		57BLA03	57BLA04	
1	N° OF POLE	6	6	
2	N° OF PHASE	3	3	
3	RATED VOLTAGE	V	36	36
4	RATED SPEED	rpm	4000	4000
5	RATED TORQUE	Nm	0,6	0,8
6	MAX PEAK TORQUE	Nm	1,8	2,4
7	TORQUE CONSTANT	Nm/A	0,06	0,07
8	LINE TO LINE RESISTANCE	Ω	0,25	0,2
9	LINE TO LINE INDUCTANCE	mH	0,4	0,25
10	MAX PEAK CURRENT	A	29	35
11	RATED CURRENT	A	10	11,43
12	NO-LOAD CURRENT	mA	580	240
13	LENGTH	mm	93,6	113,6
14	ROTOR INERTIA	$g \cdot cm^2$	510	693
15	WEIGHT	Kg	1	1,25



CONNECTION

Lead N°	Color	Gauge	Function
1	RED	UL1430 AWG26	VCC HALL SENSOR +5 TO +24 VDC
2	BLUE	UL1430 AWG26	HALL A
3	GREEN	UL1430 AWG26	HALL B
4	WHITE	UL1430 AWG26	HALL C
5	BLACK	UL1430 AWG26	HALL SENSOR GROUND
6	YELLOW	UL1430 AWG20	PHASE U
7	RED	UL1430 AWG20	PHASE V
8	BLACK	UL1430 AWG20	PHASE W

CHARACTERISTICS

Item	
HALL EFFECT ANGLE	120°
SHAFT RUN OUT	0,025 mm
INSULATION CLASS	F
RADIAL PLAY (460 g LOAD)	0,025 mm
AXIAL PLAY (4000 g LOAD)	0,025 mm
MAX RADIAL FORCE (20 mm FROM FRONT FLANGE)	115N
MAX AXIAL FORCE	45N
DIELECTRIC STRENGTH	500 VAC FOR ONE MINUTE
INSULATION RESISTANCE	100 Mohm min. 500 VDC